

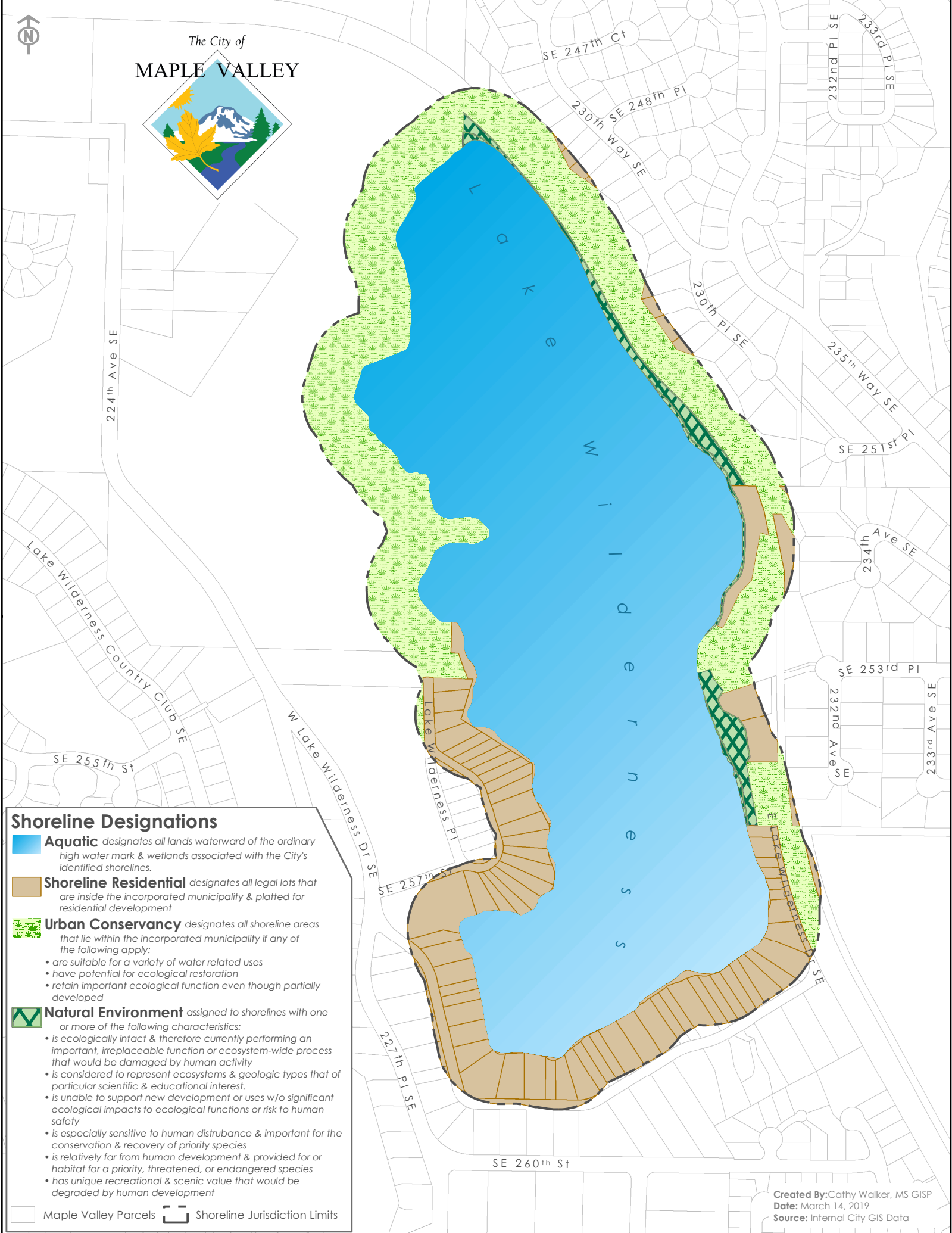





The City of  
**MAPLE VALLEY**



### Shoreline Designations

-  **Aquatic** designates all lands waterward of the ordinary high water mark & wetlands associated with the City's identified shorelines.
-  **Shoreline Residential** designates all legal lots that are inside the incorporated municipality & platted for residential development
-  **Urban Conservancy** designates all shoreline areas that lie within the incorporated municipality if any of the following apply:
  - are suitable for a variety of water related uses
  - have potential for ecological restoration
  - retain important ecological function even though partially developed
-  **Natural Environment** assigned to shorelines with one or more of the following characteristics:
  - is ecologically intact & therefore currently performing an important, irreplaceable function or ecosystem-wide process that would be damaged by human activity
  - is considered to represent ecosystems & geologic types that of particular scientific & educational interest.
  - is unable to support new development or uses w/o significant ecological impacts to ecological functions or risk to human safety
  - is especially sensitive to human disturbance & important for the conservation & recovery of priority species
  - is relatively far from human development & provided for or habitat for a priority, threatened, or endangered species
  - has unique recreational & scenic value that would be degraded by human development

 Maple Valley Parcels     Shoreline Jurisdiction Limits