



**Forest Practices Application/Notification
Office Checklist Page 1
Northwest Region**

FPAN #: 2815949
 Received Date: 7-31-17
 WDFW Concurrence Due Date: —
 WDFW Concurrence Review Completed: —
 Comments Due Date: 8-14-17
 Decision Due Date: 8-30-17
 FP Forester: SKY 30
 Shutdown Zone: 658
 RMAP #: R282009L

FPAN CLASSIFICATION: [] II <input checked="" type="checkbox"/> III [] IVG [] IVS		Biomass [] FFFPP [] 20-acre exempt []
Landowner Name: <u>Way Co</u>	Project Name: <u>Olney the Lonely</u>	
WRIA: <u>Snohomish</u>	WAU: <u>Upper Wallaw River</u>	
WRIA: _____	WAU: _____	
WRIA: _____	WAU: _____	
Legal Description: <u>SE/4 8-28-9E</u>	County: <u>Snohomish</u>	
Activity Type: Harvest <u>104</u> ac	Spray _____ ac	Stream Crossing(s) <u>11</u>
Road _____	Road _____	Rock Pit _____ ac
Construction <u>7250</u> ft	Abandonment _____ ft	Spoils _____ cy

ALTERNATIVE PRESCRIPTIONS

- Alternate Plan
- Ten-Year Forest Management Plan
- Columbia River Gorge National Scenic Area
- Watershed Analysis: _____
- Habitat Conservation Plan
- Landowner Option Plan for Northern Spotted Owl
- Cooperative Habitat Enhancement Agreement

RESOURCE REVIEW

- Unstable Slopes (Risk: Highway, Water; _____)
- Soils Map (Highly Erodible & Very Unstable)
- SLPSTAB
- Landslide Hazard Zonation
- Landslide Inventory Polygon
- Rain-on-Snow and Outside Approved WA
- Hydric Soils
- Wetland [] Forested, [] A, [] B
- In WMZ of [] A, or [] B Wetland
- In RMZ/ELZ of Type [] S, [] F, [] N water
- Water Verification
- Bull Trout Overlay
- HCP Bull Trout Population
- Bald Eagle nest or roost within 660 feet
- Group A or B Water Supply
- Hatchery (Name: _____)
- Even-Aged Harvest greater than 120 Acres
- Ground-based Equipment on Slopes greater than 40%
- Road Construction on Slopes greater than 65%
- Saltwater Islands (Name: _____)
- In or Over Typed Water
- Volume greater than 5 mbf per acre

ASSOCIATED NON-SCANNED DOCUMENTS – On file with the FPAN at the Region office.

- SEPA Checklist/Documents
- Large Landowner Road Maintenance and Abandonment Plan

ASSOCIATED SCANNED DOCUMENTS

- Conversion Option Harvest Plan
- FPHP Plans & Specifications
- Qualified Expert Report; Type: _____
- Natural Regeneration Plan
- Shoreline Permit
- Marbled Murrelet Form
- FPBM Appendix(s) _____
- Small Landowner RMAP Checklist
- CMZ Assessment Form
- Hardwood Conversion Form
- Wetland Mitigation Plan
- Water Protocol Surveys
- Modification Form# _____
- Water Classification Worksheet
- Shade Documentation (Stream Shade Assessment Worksheet)
- Watershed Analysis Worksheet
- DFC Printout
- Slope Stability Informational Form

EARR Tax Credit Yes [] No
 ADDITIONAL COMMENTS:

Form completed by J.U.
 October, 2016 Version



For DNR Region Office Use Only	
FPA/N #:	2815949
Region:	NW
Received Date:	7-31-2017

Forest Practices Application/Notification Western Washington

PLEASE USE THE INSTRUCTIONS TO COMPLETE THIS APPLICATION. TYPE OR PRINT IN INK.

1. Landowner, Timber Owner and Operator

Legal Name of LANDOWNER	Legal Name of TIMBER OWNER (if different than Landowner)	Legal Name of OPERATOR (if different than Landowner)
Weyerhaeuser Columbia Timberlands	Weyerhaeuser NR	Weyerhaeuser NR
Mailing Address: 500 Metcalf Street, Building F-5E	Mailing Address: 500 Metcalf Street, Building F-5E	Mailing Address: 500 Metcalf Street, Building F-5E
City, State, Zip Sedro-Woolley, WA 98284	City, State, Zip Sedro-Woolley, WA 98284	City, State, Zip Sedro-Woolley, WA 98284
Phone (360)424-2014	Phone (360)424-2014	Phone (360)424-2014
Email: wes.worden@weyerhaeuser.co	Email: wes.worden@weyerhaeuser.co	Email: wes.worden@weyerhaeuser.co

2. Contact Person

Contact Person: Wes Worden	Phone (509)387-0321 Email: wes.worden@weyerhaeuser.com
-------------------------------	--

3. Landownership information: See instructions

- a. No Yes Are you a small forest landowner per RCW 76.09.450?

If yes, continue to b.

- b. No Yes Is your entire proposed harvest area on a single contiguous ownership consisting of one or more parcel?

RECEIVED NW REGION
JUL 31 2017

4. If you are harvesting timber, enter the Forest Tax Reporting Account Number of the Timber Owner:

800070834

For tax reporting information or to receive a tax number, call the Department of Revenue at 1-800-548-8829.

5. Are you substituting prescriptions from an approved state or federal conservation agreement or watershed analysis?

- No Yes Write 'HCP' or 'Using Prescriptions' in tables that apply. Attach or reference prescriptions and/or crosswalks on file at the Region office.

6. What is the legal description of your forest practices?

Section	Township	Range	E/W	Tax Parcel Number	County
8	28N	9	E		Snohomish

7. When are you planning to begin work on the proposed activity? Sept or Oct 2017

8. Is the taxpayer eligible for the EARR Tax Credit?

No Yes

9. Have you reviewed this forest practices activity area to determine whether it may involve historic sites and/or Native American cultural resources? Read the instructions before answering this question.

No Yes

10. Do you have a DNR approved Road Maintenance and Abandonment Plan (RMAP)?

a. No Yes List the RMAP number: R28000009L

If no, continue to b.

b. No Yes Is a Checklist RMAP required (see instructions)?

11. Are there potentially unstable slopes or landforms in the area of your forest practices activity?

No Yes – attach Slope Stability Informational Form. If applicable, attach geotechnical report, the SEPA Environmental Checklist, HCP, or Watershed Analysis prescriptions.

12. Are there potentially unstable slopes or landforms around the area of your forest practices activity?

No Yes – attach Slope Stability Informational Form. If applicable, attach geotechnical report, HCP, or Watershed Analysis prescriptions.

13. Is this forest practice application/notification (answer every question):

a. No Yes Within city limits or inside an urban growth area? If yes, see instructions for additional required documents.

b. No Yes For road work that is included in an approved Road Maintenance and Abandonment Plan (RMAP)?

c. No Yes Within a public park? If yes, include SEPA Environmental Checklist or SEPA Determination - except for harvest/salvage of less than 5,000 board feet within a developed public park.

d. No Yes Within 500 feet of a public park? Park name: _____

e. No Yes In an approved Conversion Option Harvest Plan (COHP) from the local government? If yes, include a copy. This only applies to proposals within urban growth areas.

f. No Yes Within 200' of the Ordinary High Water Mark (OHWM) or floodway of Type S water? If yes, check with the county or city to determine whether a substantial development permit is required under the local shorelines master plan.

g. No Yes A request for a multi-year permit? If yes, length requested: 4 years or 5 years. Not everyone qualifies for a multi-year permit. See instructions for details.

- h. No Yes An Alternate Plan? If yes, include a copy.
- i. No Yes Within 50 miles of saltwater and do you own more than 500 acres of forest land in Washington State? If yes, include Marbled Murrelet Form or attach/reference HCP prescriptions.
- j. No Yes In or directly adjacent to a potential Channel Migration Zone (CMZ)? If yes, include CMZ Assessment Form. Attach/reference applicable HCP and/or Watershed Analysis prescriptions.

***** **If not working in or over typed waters, skip to Question 18** *****

You are required to verify Type Np and Ns water types within 200 feet of your proposed forest practices activities prior to submitting a Forest Practices Application / Notification. Use the Additional Information section, additional pages, the Water Type Classification Worksheet, and/or a Water Type Modification form to explain how you verified water types. See Water Typing Requirements in the instructions.

Prior to answering Questions 14-17 in this section please refer to the Forest Practices Application Instructions and Forest Practices Board Manual Section 5.

14. Are you proposing any of the following projects NOT permitted by current HPAs from WDFW?

- a. No Yes Installing, replacing, or repairing a culvert at or below the bankfull width of Type S or F water(s) that exceeds a five percent gradient?
- b. No Yes Constructing, replacing, or repairing a bridge at or below the bankfull width of unconfined streams in Type S or F water(s)?
- c. No Yes Placing fill material within the 100-year flood level of unconfined streams in Type S or F water(s)?

15. Have you consulted with DNR and/or WDFW about the proposed hydraulic project(s) in or over Type S or F water? No Yes

16. If installing, replacing, removing, or maintaining structures in or over any typed water, complete the table below. Type S and F waters require detailed plan information. Provide plan details in Question 31 or attach plan to the FPA/N. Provide crossing locations and identifiers on your Activity Map. A detailed plan with profiles may also be required for more complex hydraulic projects in Type N Waters per WAC 222-24-042(2).

Crossing Identifier (letter and/or number)	Water Type (S, F, Np, Ns)	*Existing HPA Number (if applicable)	HPA Expiration Date (if applicable)	Planned Activity (install, replace, remove, temporary, structure maintenance)	Structure (culvert, bridge, ford**, puncheon, arch, other)	Proposed Size (dimensions of structure)	Culvert Design Method (No-slope, Stream-sim, Hydraulic, Other) (F and S only)	Channel Bed Width (ft) (F and S only)	Stream Gradient (%) (F and S only)	RMAP Project (Y or N)	FFFPP Project (Y or N)
A	Ns			install	culvert	24" x 30'				N	N
B	Np				culvert	60" x 36'				N	N
C,D,I	Np				culvert	24" x 30'				N	N
J	Np				culvert	24" x 30'				N	N
E,G,H	Ns				culvert	18" x 30'				N	N
K,L	Ns				culvert	18" x 30'				N	N

*Existing HPAs issued by WDFW will be complied and enforced by WDFW until expiration. Plan details are not required for hydraulic projects permitted with an existing HPA (see instructions).

** Fords and equipment crossings on Type S and F Waters may result in an unauthorized incidental take of certain endangered or threatened fish species. For more information, see 'Background for the State's Incidental Take Permits for certain endangered and threatened fish species' following Question 24 of the FPA/N Instructions.

17. If conducting any of the following activities in or over typed water, complete the table below. Some activities will require identifiers on the Activity map and/or more information in Question 31. See instructions.

*Activity	Type S Water	Type F Water	Type Np Water	Type Ns Water
Equipment Crossing**				
Suspending Cables				
Cable Yarding				
LWD Placement/Removal				
Beaver Dam Removal				
Felling and Bucking			X	X
Other (describe in Question 31)				

*Existing HPAs issued by WDFW will be complied and enforced by WDFW until expiration. Plan details are not required for hydraulic projects permitted with an existing HPA (see instructions).

** Fords and equipment crossings on Type S and F Waters may result in an unauthorized incidental take of certain endangered or threatened fish species. For more information, see 'Background for the State's Incidental Take Permits for certain endangered and threatened fish species' following Question 24 of the FPA/N Instructions.

18. If constructing or abandoning forest roads, complete the table below. Show the road locations and identifiers on the Activity Map. Include abandonment plans for temporary roads and abandonment projects.

Road Identifier (name, number)	Road Construction		Road Abandonment	
	Length (feet)	Steepest Side-slope (%)	Length (feet)	Abandonment Date
Spur 1	3200	30		
Spur 2	650	30		
501	1700	20		
504	1700	40		

19. If depositing spoils and/or expanding or developing a rock pit for forestry use, complete the table below. Show locations and identifiers on the Activity Map.

Spoil Area Identifier (letter, number)	Amount of Spoils Deposited (cubic yards)	Rock Pit Identifier (name, number or letter)	Acres of New Rock Pit Developed	Acres of Existing Rock Pit Expanded

20. If operating in or within 200 feet of a wetland, complete the table below. Show the boundaries of each wetland, along with its identifier, and WMZ on the Activity Map. See instructions for information.

Wetland Identifier (number, letter)	Wetland Type (A, B, or Forested)	Planned Activities in Wetland	Planned Activities in Maximum Width WMZ	Total Wetland Area (acres)	How many acres will be drained?	How many acres will be filled?
W1	A	None	Harvest	0.25	0	0

***** If not harvesting or salvaging timber, skip to Question 29 *****

21. If harvesting or salvaging timber, complete the table below. Show all harvest areas and unit numbers on the Activity Map. For even-aged harvest units, also show surrounding stand information on the Activity Map.

Unit Number	Harvest Type (Even-aged, Uneven-aged, Salvage, Right-of-Way)	Biomass Harvest (Y/N)	Harvest Method (Rubber Tired Skidder, Tracked Skidder, Dozer, Shovel, Full Suspension Cable, Lead-end Suspension Cable, Helicopter, Animal, Chipper-forwarder, Slash Bundler)	Acres to be Harvested	Volume to be Harvested (mbf)	Volume to be Harvested (biomass tonnage)	Volume to be Harvested (%)	Steepest Slope in Harvest Unit (%)
1	Even-aged, Salvage*	N	Shovel	104	1700		99	70
	*Down logs including cedar shake and shingle material							

22. Reforestation. Check the appropriate box(es).

Planting. Tree Species: conifer

Natural. Include a Natural Regeneration Plan

Not required because of one or more of the following:

I am converting some or all of this land to non-forest land in the next 3 years or lands are exempted under WAC 222-34-050.

Individual dead, dying, down, or wind-thrown trees will be salvaged.

Trees are removed under a thinning program reasonably expected to maximize the long-term productivity of commercial timber.

I am leaving at least 100 vigorous, undamaged, and well-distributed saplings or merchantable trees per acre.

An average of 190 tree seedlings per acre are established on the harvest area and my harvest will not damage it.

Road right-of-way or rock pit development harvest only.

*** If you own MORE than 80 forested acres in Washington, skip to Question 27 ***

23. Are you using the exempt 20-acre parcel riparian management zone (RMZ) rule on type S, F, or Np waters?

No If no, continue to Question 27.

Yes If yes, continue to Question 24. See instructions for qualifications and information.

24. Choose the answer below that best fits your situation. Show all RMZs on the Activity Map.

a. ALL of the following apply to me and my land: (If no, answer b.)

- Between June 5, 2006 and today's date I have always owned less than 80 acres of forestland in Washington.

- Between June 5, 2006 and today's date this parcel has always been 20 acres or less of contiguous ownership. See RCW 76.09.020 for definition of 'contiguous'.

- Between June 5, 2006 and today's date this parcel has always been owned by me or someone else that has owned less than 80 acres of forestland in Washington.

b. ONE OR MORE of the following apply to me and/or my land (check all that apply):

- I currently own more than 80 acres of forestland in Washington.
- Between June 5, 2006 and today's date I have owned more than 80 acres of forestland in Washington.
- Between June 5, 2006 and today's date this parcel has been a part of more than 20 acres of contiguous ownership. See RCW 76.09.020 for definition of 'contiguous'.
- Between June 5, 2006 and today's date this parcel has been owned by someone that has owned more than 80 forested acres in Washington.

If any of the statements in (b) above apply AND you use the 20-acre exempt RMZ rule, you are NOT authorized under the State's Incidental Take Permits (see explanation in FPA instructions under Questions 24).

25. If harvesting within 115 feet of a Type S or F water on an exempt 20-acre parcel, complete the table below. Show RMZs and stream segment identifiers on the Activity Map. If you are harvesting within 75 feet or within the maximum RMZ (whichever is less), stream shade must be assessed and met following harvest. Describe how stream shade was determined to be met, using the 'Stream Shade Assessment Worksheet' if necessary.

Stream Segment Identifier (letter)	Water Type (S, F)	Segment Length (feet)	Bankfull Width (feet)	Maximum RMZ Width (feet)	Are you harvesting within the maximum RMZ? (Y or N)

26. Are you harvesting within 29 feet of a Type Np water on a 20-acre exempt parcel?

- No Continue to Question 29.
- Yes See instructions and describe leave tree strategy in Question 31. Then continue to Question 29.

27. If harvesting within 200 feet of any of Type S or F water, complete the table below. Include DFC for all inner zone harvests unless you have an HCP prescription. Show RMZs, CMZs, and stream segment identifiers on the Activity Map. If you are harvesting within 75 feet or within the maximum RMZ (whichever is less), stream shade must be assessed and met following harvest. Describe how stream shade was determined to be met, using the 'Stream Shade Assessment Worksheet' if necessary.

Stream Segment Identifier (letter)	Water Type (S or F)	Site Class (I - V)	Stream Width (feet)	Is there a CMZ? (Y/N)	RMZ Harvest Code(s) (see instructions)	DFC Run Number	Total width of RMZ (feet)

Fr 2815949

28. If harvesting within 50 feet of Type Np water, complete the table(s) below. Show RMZs and stream segment identifiers on the Activity Map.

Stream Segment Identifier (letter)	Total Stream Length in Harvest Unit (feet)	Length of No-Harvest, 50-foot Buffers in Harvest Unit (feet)	Stream Segment Identifier (letter)	Total Stream Length in Harvest Unit (feet)	Length of No-Harvest, 50-foot Buffers in Harvest Unit (feet)
Np1-Np12	7300	3650			

29. How are the following marked on the ground? (Flagging, paint, road, fence, etc.)

Harvest Boundaries: against roads, blue flagging on north, east, and south lines, pink flagging otherwise

Clumped Wildlife Reserve Trees/Green Recruitment Trees: within rmzs

Right-of-way limits/road centerlines: orange flagging or existing grades

Stream Crossing Work: where streams intersect old grades or orange flagging

Riparian Management Zone Boundaries and Leave/Take Trees: pink flagging

Channel Migration Zone: not applicable

Wetland Management Zone Boundaries and Leave/Take Trees: pink flagging

30. Are you converting the land to non-forestry use within 3 years of harvest?

No Yes If yes, include your SEPA Determination and/or SEPA checklist.

31. Additional Information (attach additional pages if necessary): For hydraulic projects in or over Type S, F, or complex N water(s) see instructions for required plan information.

"Olney the Lonely", HUN 15148.

Wetland W1 is a bog. It is protected with a wetland management zone that averages at least 50 feet but has a minimum width of 25 feet.



Culvert sizes were determined as follows using method A from the DNR Board Manual:

Crossings E,G,H,K,L: 1' wide x 3" deep
 Crossings A,C,D,I,J: 2' wide x 3" deep
 Crossing B: 6' wide x 12" deep

32. We acknowledge the following:

- The information on this application/notification is true.
- We understand this proposed forest practice is subject to:
 - The Forest Practices Act and Rules AND
 - All other federal, state or local regulations.
- Compliance with the Forest Practices Act and Rules does not ensure compliance with the Endangered Species Act or other federal, state or local laws.
- If we said that we would not convert the land to non-forestry use, the county or city may deny development permits on this parcel for the next 6 years.
- The following may result in an unauthorized incidental take of certain endangered or threatened fish species:
 - Conversion of land to non-forestry use.
 - Harvesting within the maximum RMZ on a 20-acre exempt parcel that was acquired after June 5, 2006.
 - Equipment Crossings/Fords in or over Type S and F Waters.
- Inadvertent Discovery – Chapters 27.44, 27.53, 68.50 and 68.60 RCW
 - If you find or suspect you have found an archaeological object or Native American cairn, grave, or glyptic record, immediately cease disturbance activity, protect the area and promptly contact the Department of Archaeology and Historic Preservation at 360 586-3077.
 - If you find or suspect you have found human skeletal remains, immediately cease disturbance activity, protect the area, and contact the County Coroner or Medical Examiner and local law enforcement as soon as possible. Failure to report human remains is a misdemeanor.

The landowner understands that by signing and submitting this FPA, he/she is authorizing the Department of Natural Resources to enter the property in order to review the proposal, inspect harvest operations, and monitor compliance for up to three years after its expiration date. RCW 76.09.150

Signature of LANDOWNER  Print Name: Wes Worden Date: 07/27/2017	Signature of TIMBER OWNER* (If different than landowner)  Print Name: Wes Worden Date: 07/27/2017	Signature of OPERATOR (If different than landowner)  Print Name: Wes Worden Date: 07/27/2017
---	---	---

** NOTE: If you are a "Perpetual Timber Rights Owner," and are submitting this without the Landowner's Signature, provide written evidence the landowner has been notified.*

Please make a copy of this FPA/N for your records. If this FPA/N contains a hydraulic project requiring WDFW concurrence review, it will not be available online for public review until after the WDFW concurrence review period.

FPA for: Olney the Lonely
 HUN 15148
 104.2 Acres

WY Columbia Timberlands
 47 55'27"N 121 40'26"W
 RMZ 9.1 acres Inop 3.5 acres
 Unstable 0.1 acres

Chelan Tree Farm
 Snohomish County
 T28N R09E sec 08

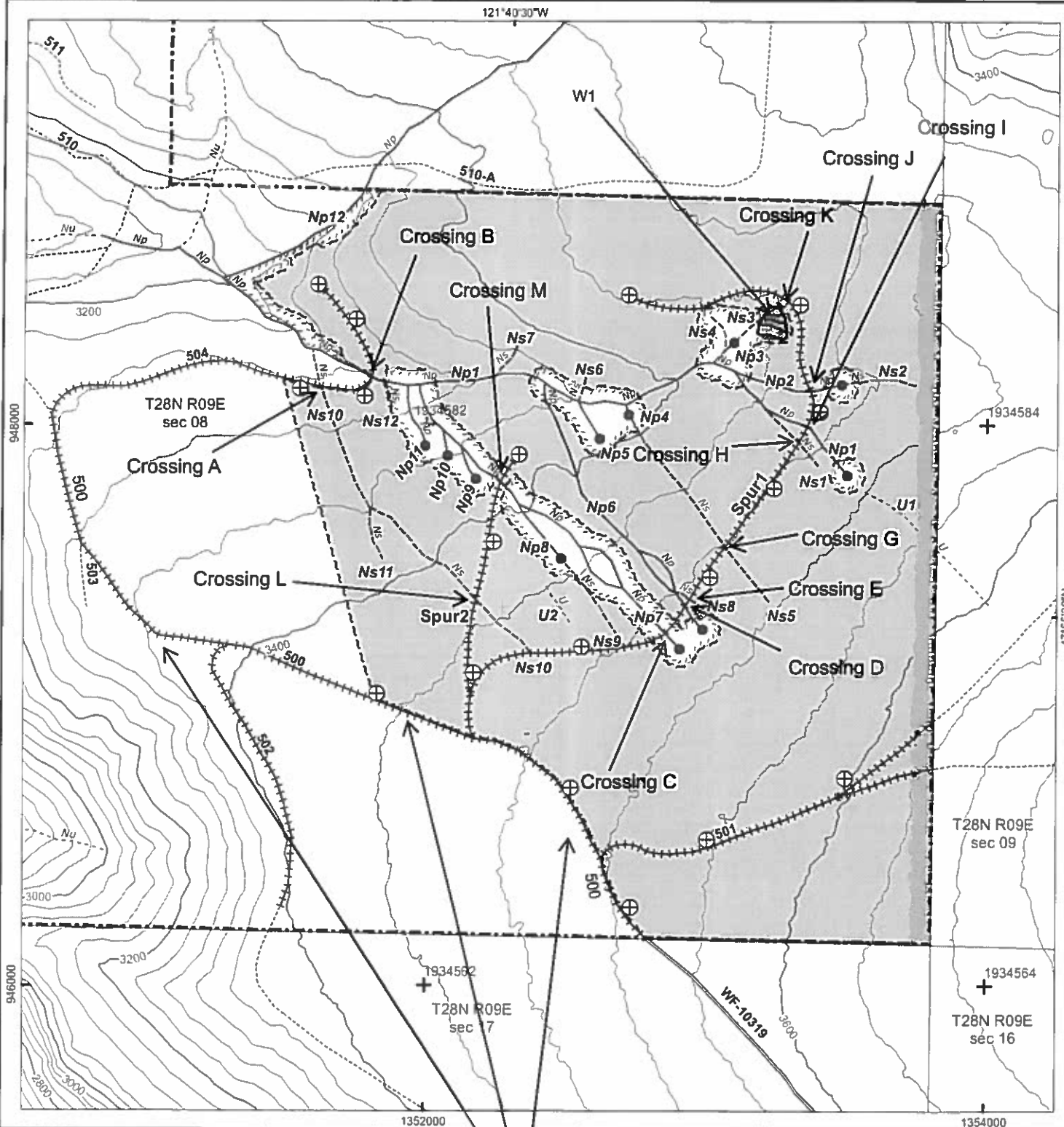

EMERGENCY MEDICAL EVACUATION

Call: 911
 Lifelight: 1-800-452-7434

Road Construction on 500 Road
 Proposed Under FPA 2815879



- | | | | | | |
|-------|-------------------------|---|----------------------------|------------------------|------------------|
| + | DNR Registration Points | ● | Perennial Initiation Point | [Dashed Box] | Harvest |
| ⊕ | Landings | * | Regulatory End of Fish | [Horizontal Lines Box] | Other Leave Area |
| +++++ | New Road Construction | ~ | Type Np Stream | [Dotted Box] | RMZ |
| ----- | WCT Property Line | ~ | Type Ns Stream | | |
| ~ | 40ft Contours | ~ | Untyped Stream | | |

Ft. 2815949



1 inch = 500 feet

7/20/2017

Appendix D. Slope Stability Informational Form

Complete and attach this form to your FPA if you answered 'Yes' to FPA Question 11 or 12. Refer to WAC 222-16-050(1)(d) and Forest Practices Board Manual Section 16—*Guidelines for Evaluating Potentially Unstable Slopes* for definitions and descriptions of potentially unstable slopes or landforms.

1. What screening tools were used? Aerial Photo, LiDAR, Landslide Inventory, Landslide Hazard Zone Polygon, GIS/Other (describe):

2. Were there any features identified using the screening tools in #1 that did not exist in the field? If yes, describe:

No

3. a. What potentially unstable slopes or landforms were identified in the area of your forest practices activity?

Check all that apply:

- Inner Gorge Groundwater recharge areas for glacial deep-seated landslides
 Bedrock Hollow Convergent Headwall Toe of deep-seated landslide
 Outer edges of meander bends
 Other (Deep-seated landslides or other features of potentially unstable slopes). Describe:

b. What activities may occur in potentially unstable slopes or landforms? Check all that apply:

- Timber harvest Road construction Suspending cables Yarding Tailholds

4. a. What potentially unstable slopes or landforms were identified around the area of your forest practices activity?

Check all that apply:

- Inner Gorge Groundwater recharge areas for glacial deep-seated landslides
 Bedrock Hollow Convergent Headwall Toe of deep-seated landslide
 Outer edges of meander bends
 Other (Deep-seated landslides or other features of potentially unstable slopes). Describe:

b. What activities may occur around potentially unstable slopes or landforms? Check all that apply:

- Timber harvest Road construction Suspending cables Yarding Tailholds

5. If any features identified in #3.a. and /or #4.a. were bounded out, describe the manner in which the boundary was determined:

Along Np12 and the westernmost length of Np1 (to the west of crossing B) inner gorge features were bound out where slopes exceeding 70% adjacent to the streams.

6. Were areas of public use (which may include, but are not limited to: public roads, utilities, designated recreation areas, occupied structures, etc.) identified in or around the area of your proposed forest practices activity? Show these locations on the map in #8.

No

7. Date of field review: July 2017

Person(s) that conducted field review:	Wes Worden	Harvest Manager
	Name	Title/position
	Name Title/position	

8. Show all field reviewed areas for potentially unstable slopes or landforms on a map (may use a forest practices activity map, harvest map or GIS map – See example below). Show locations where areas of public use exist. **This map is intended to be developed by the field practitioner.**

FPA for: Olney the Lonely
 HUN 15148
 104.2 Acres

WY Columbia Timberlands
 47 55'27"N 121 40'26"W
 RMZ 9.1 acres Inop 3.5 acres
 Unstable 0.1 acres

Chelan Tree Farm
 Snohomish County
 T28N R09E sec 08

Unstable Slopes

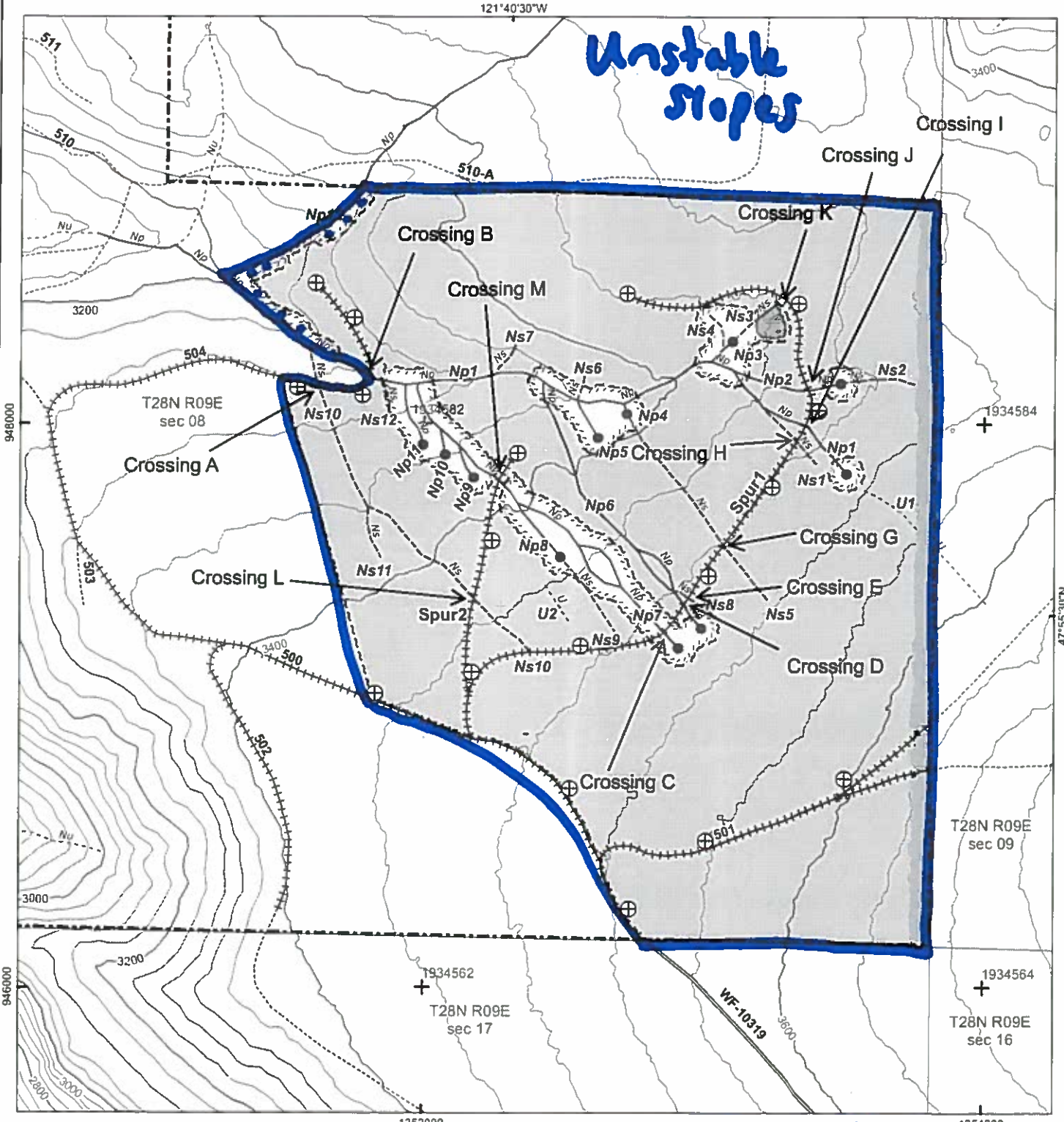

EMERGENCY MEDICAL EVACUATION

Call: 911
 Lifeflight: 1-800-452-7434

○ = screened for unstable slopes

- | | | | | | |
|------|-------------------------|---|----------------------------|----|-----------------------------------|
| + | DNR Registration Points | ● | Perennial Initiation Point | ▨ | Harvest |
| ⊕ | Landings | * | Regulatory End of Fish | ▨ | Other Leave Area |
| ++++ | New Road Construction | ~ | Type Np Stream | ▨ | RMZ |
| ---- | WCT Property Line | ~ | Type Ns Stream | ●● | <i>Field Verified Inner Gorge</i> |
| --- | 40ft Contours | ~ | Untyped Stream | | |



1 inch = 500 feet

F 2015949 7/20/2017

Appendix A. Western Washington Water Type Classification Worksheet

Stream/Segment ID: Np1-Np12 Stream/Segment ID: Ns1-Ns11 Stream/Segment ID: U1, U2

Date Observed: August 2016 Date Observed: August 2016 Date Observed: August 2016

1. **Do you have a protocol survey? (See the Board Manual Section 13) Or, does the stream have waiver characteristics? (See WAC 222-16-031(3) (b) (ii))**

<input checked="" type="checkbox"/> No. Continue. <input type="checkbox"/> Yes. Attach documentation or approved WTMF number: <hr style="width: 100%;"/> <input type="checkbox"/> Fish found. Stop. <input type="checkbox"/> No fish found. Go to 6.	<input checked="" type="checkbox"/> No. Continue. <input type="checkbox"/> Yes. Attach documentation or approved WTMF number: <hr style="width: 100%;"/> <input type="checkbox"/> Fish found. Stop. <input type="checkbox"/> No fish found. Go to 6.	<input checked="" type="checkbox"/> No. Continue. <input type="checkbox"/> Yes. Attach documentation or approved WTMF number: <hr style="width: 100%;"/> <input type="checkbox"/> Fish found. Stop. <input type="checkbox"/> No fish found. Go to 6.
---	---	---

2. **Were fish observed or are fish known to use the stream any time of the year?**

<input type="checkbox"/> Yes. Type F water. Stop. <input checked="" type="checkbox"/> No. Continue.	<input type="checkbox"/> Yes. Type F water. Stop. <input checked="" type="checkbox"/> No. Continue.	<input type="checkbox"/> Yes. Type F water. Stop. <input checked="" type="checkbox"/> No. Continue.
--	--	--

3. **Is there an impoundment (ponded water) upstream of the assessed segment, that is greater than .5 acres?**

<input type="checkbox"/> Yes. Type F water. Stop. <input checked="" type="checkbox"/> No. Continue.	<input type="checkbox"/> Yes. Type F water. Stop. <input checked="" type="checkbox"/> No. Continue.	<input type="checkbox"/> Yes. Type F water. Stop. <input checked="" type="checkbox"/> No. Continue.
--	--	--

4. **Are there segments within or above the assessed portion of the stream where the average BFW is two feet or greater? AND the average stream gradient is less than or equal to 16%?**

<input type="checkbox"/> Yes. Type F water. Stop. <input checked="" type="checkbox"/> No. Continue.	<input type="checkbox"/> Yes. Type F water. Stop. <input checked="" type="checkbox"/> No. Continue.	<input type="checkbox"/> Yes. Type F water. Stop. <input checked="" type="checkbox"/> No. Continue.
--	--	--

5. **Are there segments within or above the assessed portion of the stream where the average BFW is two feet or greater? AND the average stream gradient is between 16% and 20%? AND, the contributing basin to the stream is greater than 50 acres?**

<input type="checkbox"/> Yes. Type F water. Stop. <input checked="" type="checkbox"/> No. Continue.	<input type="checkbox"/> Yes. Type F water. Stop. <input checked="" type="checkbox"/> No. Continue.	<input type="checkbox"/> Yes. Type F water. Stop. <input checked="" type="checkbox"/> No. Continue.
--	--	--

6. **Does the stream segment contain water at all times during a normal rainfall year?**

<input checked="" type="checkbox"/> Yes. Type Np water. Go to 9. <input type="checkbox"/> No. Continue.	<input type="checkbox"/> Yes. Type Np water. Go to 9. <input checked="" type="checkbox"/> No. Continue.	<input type="checkbox"/> Yes. Type Np water. Go to 9. <input checked="" type="checkbox"/> No. Continue.
--	--	--

7. **Is the stream segment downstream of a perennial source of water?**

<input type="checkbox"/> Yes. Type Np water. Go to 9. <input type="checkbox"/> No. Continue.	<input type="checkbox"/> Yes. Type Np water. Go to 9. <input checked="" type="checkbox"/> No. Continue.	<input type="checkbox"/> Yes. Type Np water. Go to 9. <input checked="" type="checkbox"/> No. Continue.
---	--	--

8. **Is the stream physically connected by an above-ground channel to Type S, F, or Np water?**

<input type="checkbox"/> Yes, Type Ns water. Stop. <input type="checkbox"/> No, non-typed water.	<input checked="" type="checkbox"/> Yes, Type Ns water. Stop. <input type="checkbox"/> No, non-typed water.	<input type="checkbox"/> Yes, Type Ns water. Stop. <input checked="" type="checkbox"/> No, non-typed water.
---	--	--

9. **Describe how you determined the uppermost point of perennial flow. Include a description of its location and show the point on a map (Use a separate piece of paper if necessary).**

Stream/Segment ID see below Description:

Np1-Np11: followed drainage to end of flow, walked upslope to determine end of channel
 Np12: stream extends beyond Weyerhaeuser ownership

Marbled Murrelet Form

Western Washington Forest Practices Application/Notification

**Complete this form only if you are harvesting timber (including salvage) or constructing roads.
Do not complete this form if you have an HCP for marbled murrelets.**

Answer every question.

1. No Yes For this FPA/N, has a protocol survey(s) been completed that includes:
- Harvest units (and within 300 ft on your ownership), or
 - Salvage units (and within 300 ft on your ownership), or
 - Any area of proposed road construction (and within 300 ft on your ownership)?

If 'Yes', fill out the table and check the appropriate findings below.

Survey ID (Name or Unit #)	Township, Range, & Section	Survey was approved by WDFW (Attach approval letter from WDFW)	Survey was disapproved by WDFW and is being resubmitted with this FPA/N (Explain below)	Survey has been submitted to WDFW and survey approval is unknown (Explain below)	Survey is complete but has not yet been submitted to WDFW (Submit survey with FPA/N)
		<input type="checkbox"/> Occupancy <input type="checkbox"/> Presence <input type="checkbox"/> No Detections	<input type="checkbox"/> Occupancy <input type="checkbox"/> Presence <input type="checkbox"/> No Detections	<input type="checkbox"/> Occupancy <input type="checkbox"/> Presence <input type="checkbox"/> No Detections	<input type="checkbox"/> Occupancy <input type="checkbox"/> Presence <input type="checkbox"/> No Detections
		<input type="checkbox"/> Occupancy <input type="checkbox"/> Presence <input type="checkbox"/> No Detections	<input type="checkbox"/> Occupancy <input type="checkbox"/> Presence <input type="checkbox"/> No Detections	<input type="checkbox"/> Occupancy <input type="checkbox"/> Presence <input type="checkbox"/> No Detections	<input type="checkbox"/> Occupancy <input type="checkbox"/> Presence <input type="checkbox"/> No Detections
		<input type="checkbox"/> Occupancy <input type="checkbox"/> Presence <input type="checkbox"/> No Detections	<input type="checkbox"/> Occupancy <input type="checkbox"/> Presence <input type="checkbox"/> No Detections	<input type="checkbox"/> Occupancy <input type="checkbox"/> Presence <input type="checkbox"/> No Detections	<input type="checkbox"/> Occupancy <input type="checkbox"/> Presence <input type="checkbox"/> No Detections

Explanation:

2. No Yes Unknown Will you harvest, salvage, or construct roads within 0.25 miles of an occupied site?

3. No Yes Unknown Will you fly helicopter(s) over or within 0.25 miles of an occupied site?

4. No Yes Will you harvest *live* trees in a buffer of an occupied site?

If Yes, describe the leave trees and buffer widths you will leave. **NOTE:**
If you leave less than required in WAC 222-16-080(1) (j) (v) this is a Class IV-Special and an Environmental Checklist is required

Description of managed buffers:

5. No Yes

Are there nesting platforms within any harvest unit (including salvage and road construction) that are within 300 feet that:

- Are not located within a surveyed area, **and**;
- Have a minimum of 2 platforms per acre, **and**;
- Are located within 7 or more acres of contiguous habitat, **and**;
- Have a least 40% (number not volume) of the dominant and co-dominant trees made up of Douglas-fir, western hemlock, western red cedar, or Sitka spruce?

If "Yes", complete the table below for those areas.

Name or # (as shown on map) of delineated stands of contiguous habitat	Delineated stand acres	Nesting platforms per acre	Number of trees 32 inches dbh or greater with platforms	Platform Assessment Method Field Sampling Method, Sample Plot Method, 100% Cruise Method, Inventory Model Method, or Other

6. No Yes

Are there areas within this forest practice or within 300 feet that:

- Are not surveyed, **and**;
- Are not listed in question 5, **and**;
- Have trees that are at least 32 inches dbh

If "Yes", list the forest practice unit numbers from your activity map. Provide brief description of current stand conditions. Such as tree species composition, stand age (if known), and maximum tree size (dbh).

Harvest Unit #(s) 1 Within the Unit Within 300 feet of the Unit

Description:

There are some scattered Doug-fir Alaska yellow cedar approx 36" Dbh max within the harvest unit but they do not comprise 7 acres of contiguous habitat.

Harvest Unit #(s) _____ Within the Unit Within 300 feet of the Unit

Description:

Harvest Unit #(s) _____ Within the Unit Within 300 feet of the Unit

Description:

7. If you answered yes to question 1, 4, or 5, include a map (separate from your map that shows your harvest units and/or road construction) See the instructions for the information required on each map.



Forest Practices Application/Notification
Notice of Decision

FPA/N No: 2815949
Effective Date: 8/29/2017
Expiration Date: 8/29/2020
Shut Down Zone: 658
EARR Tax Credit: Eligible Non-eligible
Reference: Olney The Lonely

Decision

- Notification Operations shall not begin before the effective date.
- Approved This Forest Practices Application is subject to the conditions listed below.
- Disapproved This Forest Practices Application is disapproved for the reasons listed below.
- Closed Applicant has withdrawn FPA/N.

FPA/N Classification

Number of Years Granted on Multi-Year Request

Class II Class III Class IVG Class IVS 4 years 5 years

Conditions on Approval / Reasons for Disapproval

No additional conditions.

FOR YOUR INFORMATION:

Please notify DNR Northwest Region Office (360-856-3500) 48 business hours before commencing timber harvest operations. Please provide the application number and legal description for your operation.

Issued By: Steven Huang *L.H.* Region: Northwest

Title: Skykomish Forest Practice Forester Date: 8/29/2017

Copies to: Landowner, Timber Owner and Operator.

Issued in person: Landowner Timber Owner Operator By: _____

Appeal Information

You have thirty (30) days to appeal this Decision and any related State Environmental Policy Act determinations to the Pollution Control Hearings Board in writing at the following addresses:

Physical address: 1111 Israel Rd. SW, Ste 301, Tumwater, WA 98501

Mailing address: P.O. BOX 40903, OLYMPIA, WA 98504-0903

Information regarding the Pollution Control Hearings Board can be found at: <http://www.eluho.wa.gov/>

At the same time you file an appeal with the Pollution Control Hearings Board, also send a copy of the appeal to the Department of Natural Resources' region office and the Office of the Attorney General at the following addresses:

Office of the Attorney General
Natural Resources Division
1125 Washington Street SE
PO Box 40100
Olympia, WA 98504-0100

And

Department Of Natural Resources
Northwest Region
919 N Township St
Sedro-Woolley WA 98284

Other Applicable Laws

Operating as described in this application/notification does not ensure compliance with the Endangered Species Act, or other federal, state, or local laws.

Transfer of Forest Practices Application/Notification (WAC 222-20-010)

Use the "Notice of Transfer of Approved Forest Practices Application/Notification" form. This form is available at region offices and on the Forest Practices website: <http://www.dnr.wa.gov/businesspermits/forestpractices>. Notify DNR of new Operators within 48 hours.

Continuing Forest Land Obligations (RCW 76.09.060, RCW 76.09.070, RCW 76.09.390, and WAC 222-20-055)

Obligations include reforestation, road maintenance and abandonment plans, conversions of forest land to non-forestry use and/or harvest strategies on perennial non-fish habitat (Type Np) waters in Eastern Washington.

Before the sale or transfer of land or perpetual timber rights subject to continuing forest land obligations, the seller must notify the buyer of such an obligation on a form titled "Notice of Continuing Forest Land Obligation". The seller and buyer must both sign the "Notice of Continuing Forest Land Obligation" form and send it to the DNR Region Office for retention. This form is available at DNR region offices.

If the seller fails to notify the buyer about the continuing forest land obligation, the seller must pay the buyer's costs related to continuing forest land obligations, including all legal costs and reasonable attorneys' fees incurred by the buyer in enforcing the continuing forest land obligation against the seller.

Failure by the seller to send the required notice to the DNR at the time of sale will be prima facie evidence in an action by the buyer against the seller for costs related to the continuing forest land obligation prior to sale.

DNR affidavit of mailing:

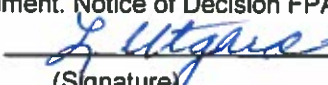
On this day <u>8/29/2017</u>	I placed in the United States mail at <u>Sedro-Woolley</u> , WA,
(date)	(post office location)
postage paid, a true and accurate copy of this document. Notice of Decision FPA # <u>2815949</u>	
<u>L Utgard</u>	
(Printed name)	(Signature)



RECEIVED
AUG 03 2018
NW REGION

Forest Practices Application/Notification NOTICE OF TRANSFER

Olney the Lonely Row
CEL

I/we transfer my/our rights, privileges, and obligations under this approved Forest Practices Application or Notification. I/we affirm that the information contained below is true and agree to comply with the rules authorized by the Forest Practices Act and be bound by all conditions on the approved application or notification.

FPA/N Number: 2815949 Section(s): 8 Township: 28 Range: 9

Original Landowner (Signature): *Weyerhaeuser*

Original Landowner (Printed): Weyerhaeuser Company Date: 7/31/18

New Operator – Complete this section **only** if you are:

Changing an operator for: Road construction Timber harvest Aerial spray
 Adding an operator for: Road construction Timber harvest Aerial spray

Legal Name of New Operator: (Print) Cascade H & A Mailing Address: PO Box 83
Snohomish, WA 98291 - 0083

Phone: 3260-435-9614
 Email: cascade.dale@gmail.com

New Operator Signature: *Dale* Date: 7/31/18

New Landowner – Complete this section **only** if you are transferring your FPA to a new landowner

No Yes Are you a small forest landowner per RCW 76.09.450 (if yes, continue to question below)
 No Yes Is your entire proposed harvest area on a single contiguous ownership consisting of one or more parcel(s)?

Legal Name of New Landowner: (Print) _____ Mailing Address: _____

Phone: _____
 Email: _____

New Landowner Signature: _____ Date: _____

New Timber Owner – Complete this section **only** if you are transferring your timber rights

Legal Name of Timber Owner: (Print) _____ Mailing Address: _____

Phone: _____
 Email: _____

Forest Tax Reporting Account Number: (Contact Dept. of Revenue at: 1-800-548-8829)
800 070 834

New Timber Owner Signature: _____ Date: _____

Received by: *J. Utgard* Date: 8/7/18

(DNR Forest Practices Staff Signature) 11/01/2017



RECEIVED
SEP 13 2018
NW REGION

Forest Practices Application/Notification NOTICE OF TRANSFER

I/we transfer my/our rights, privileges, and obligations under this approved Forest Practices Application or Notification. I/we affirm that the information contained below is true and agree to comply with the rules authorized by the Forest Practices Act and be bound by all conditions on the approved application or notification.

FPA/N Number: 2815949 Section(s): 8 Township: 28N Range: 9E

Original Landowner (Signature): [Signature]

Original Landowner (Printed): Wes Worden Date: 9 / 6 / 2018

New Operator – Complete this section only if you are:

Changing an operator for: Road construction Timber harvest Aerial spray
 Adding an operator for: Road construction Timber harvest Aerial spray

Legal Name of New Operator: (Print) Rob Allen Mailing Address: 29133 407th Ave NE
 Phone: 425-327-9067 ABFM@yubra.com Arlington WA 98223
 Email: alenaire@aol.com

New Operator Signature: [Signature] Date: 9/6/18

New Landowner – Complete this section only if you are transferring your FPA to a new landowner

No Yes Are you a small forest landowner per RCW 76.09.450 (if yes, continue to question below)
 No Yes Is your entire proposed harvest area on a single contiguous ownership consisting of one or more parcel(s)?

Legal Name of New Landowner: (Print) _____ Mailing Address: _____
 Phone: _____
 Email: _____

New Landowner Signature: _____ Date: _____

New Timber Owner – Complete this section only if you are transferring your timber rights

Legal Name of Timber Owner: (Print) _____ Mailing Address: _____
 Phone: _____
 Email: _____

Forest Tax Reporting Account Number: (Contact Dept. of Revenue at: 1-800-548-8829)

New Timber Owner Signature: _____ Date: _____

Received by: [Signature] Date: 9/13/18
 (DNR Forest Practices Staff Signature) 11/01/2017