



FPA/N No: 2815645

Effective Date: 3/1/2017

Expiration Date: 3/1/2020

**Forest Practices Application/Notification
 Notice of Decision**

Shut Down Zone: 656

EARR Tax Credit: Eligible Non-eligible

Reference: Brenner

DECISION:

- NOTIFICATION** Operations shall not begin before the effective date.
- APPROVED** This Forest Practices Application is subject to the conditions listed below.
- DISAPPROVED** This Forest Practices Application is disapproved for the reasons listed below.
- CLOSED** Applicant has withdrawn FPA/N.

FPA/N CLASSIFICATION

Number of Years Granted on Multi-Year Request

Class II Class III Class IVG Class IVS 4yrs 5 yrs

Conditions on Approval / Reasons for Disapproval

Please Note:
 Harvest debris created by this operation may create an "extreme hazard" which requires treatment. WAC 332-24-650 requires that any harvest debris within 100 feet of public roads, or within 200-500 feet of residences or public buildings must be abated. Abatement may be accomplished by burning, chipping, or removing the slash.

Issued By: Steven Huang *S.H.*

Region: Northwest

Title: Skykomish Forest Practice Forester

Date: 2/24/2017

Copies to: Landowner, Timber Owner and Operator

Issued in Person: Landowner Timber Owner Operator By: _____

Appeal Information

You have thirty (30) days to appeal this Decision and any related State Environmental Policy Act determinations to the Pollution Control Hearings Board in writing at the following addresses:

Physical address: 1111 Israel Rd. SW, Ste 301, Tumwater, WA 98501

Mailing address: P.O. BOX 40903, OLYMPIA, WA 98504-0903

Information regarding the Pollution Control Hearings Board can be found at: <http://www.eluho.wa.gov/>

At the same time you file an appeal with the Pollution Control Hearings Board, also send a copy of the appeal to the Department of Natural Resources' region office and the Office of the Attorney General at the following addresses:

Office of the Attorney General
Natural Resources Division
1125 Washington Street SE
PO Box 40100
Olympia, WA 98504-0100

And

Department Of Natural Resources
Northwest Region
919 N Township Street
Sedro-Woolley, WA 98284

Other Applicable Laws

Operating as described in this application/notification does not ensure compliance with the Endangered Species Act, or other federal, state, or local laws.

Hydraulic Project Approval (HPA) (Chapter 77.55RCW and WAC 222-50-020(2))

The Department of Fish and Wildlife (WDFW), as the jurisdictional agency issuing HPAs, has final authority for approving water crossing structures in Type S and F waters. WDFW continues to have authority on Type N waters and may exercise that authority on some Type N waters.

Notice: The HPA water crossing requirements supersede what is indicated on the FPA. Landowners are required by law to follow the provisions as directed on the HPA.

Transfer of Forest Practices Application/Notification (WAC 222-20-010)

Use the "Notice of Transfer of Approved Forest Practices Application/Notification" form. This form is available at region offices and on the Forest Practices Division website: <http://www.dnr.wa.gov/businesspermits/forestpractices>. Notify DNR of new Operators within 48 hours.

Continuing Forest Land Obligations (RCW 76.09.060, RCW 76.09.070, RCW 76.09.390, and WAC 222-20-055)

Obligations include reforestation, road maintenance and abandonment plans, conversions of forest land to non-forestry use and/or harvest strategies on perennial non-fish habitat (Type Np) waters in Eastern Washington.

Before the sale or transfer of land or perpetual timber rights subject to continuing forest land obligations, the seller must notify the buyer of such an obligation on a form titled "Notice of Continuing Forest Land Obligation". The seller and buyer must both sign the "Notice of Continuing Forest Land Obligation" form and send it to the DNR Region Office for retention. This form is available at DNR region offices.

If the seller fails to notify the buyer about the continuing forest land obligation, the seller must pay the buyer's costs related to continuing forest land obligations, including all legal costs and reasonable attorneys' fees incurred by the buyer in enforcing the continuing forest land obligation against the seller.

Failure by the seller to send the required notice to the DNR at the time of sale will be prima facie evidence in an action by the buyer against the seller for costs related to the continuing forest land obligation prior to sale.

DNR affidavit of mailing:

On this day 2-24-17, I placed in the United States mail at Sedro-Woolley, WA, postage paid, a true and accurate copy of the attached document. Notice of Decision FPA # 2815645

L Utgard
(Printed name)

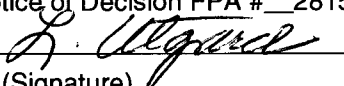
(Signature)



**Forest Practices Application/Notification
Office Checklist Page 1
Northwest Region**

FPA/N #: 2815645

Received Date: 2-24-17

WDFW Concurrence Due Date: —

WDFW Concurrence Review Completed: —

Comments Due Date: 3-1-17

Decision Due Date: 3-1-17

FP Forester: SK430

Shutdown Zone: 656

RMAP #: —

FPA/N CLASSIFICATION: <input checked="" type="checkbox"/> II <input type="checkbox"/> III <input type="checkbox"/> IVG <input type="checkbox"/> IVS		Biomass <input type="checkbox"/> FFFPP <input type="checkbox"/> 20-acre exempt <input type="checkbox"/>	
Landowner Name: <u>Brenner</u>	Project Name:		
WRIA: <u>Snokomish</u>	WAU: <u>Everett</u>		
WRIA: _____	WAU: _____		
WRIA: _____	WAU: _____		
Legal Description: <u>NESE 15-28-6E</u>	County: <u>Snokomish</u>		
Activity Type: Harvest <u>8.4</u> ac	Spray _____ ac	Stream Crossing(s) _____	
Road _____	Road _____	Rock Pit _____ ac	
Construction _____ ft	Abandonment _____ ft	Spoils _____ cy	

ALTERNATIVE PRESCRIPTIONS

- Alternate Plan
- Ten-Year Forest Management Plan
- Columbia River Gorge National Scenic Area
- Watershed Analysis: _____
- Habitat Conservation Plan
- Landowner Option Plan for Northern Spotted Owl
- Cooperative Habitat Enhancement Agreement

RESOURCE REVIEW

- Unstable Slopes (Risk: Highway, Water; _____)
 - Soils Map (Highly Erodible & Very Unstable)
 - SLPSTAB
 - Landslide Hazard Zonation
 - Landslide Inventory Polygon
- Rain-on-Snow and Outside Approved WA
- Hydric Soils
 - Wetland Forested, A, B
- In WMZ of A, or B Wetland
- In RMZ/ELZ of Type S, F, N water
- Water Verification
- Bull Trout Overlay
- HCP Bull Trout Population
- Bald Eagle nest or roost within 660 feet
- Group A or B Water Supply
- Hatchery (Name: _____)
- Even-Aged Harvest greater than 120 Acres
- Ground-based Equipment on Slopes greater than 40%
- Road Construction on Slopes greater than 65%
- Saltwater Islands (Name: _____)
- In or Over Typed Water
- Volume greater than 5 mbf per acre

ASSOCIATED NON-SCANNED DOCUMENTS – On file with the FPA/N at the Region office.

- SEPA Checklist/Documents
- Large Landowner Road Maintenance and Abandonment Plan

ASSOCIATED SCANNED DOCUMENTS

- Conversion Option Harvest Plan
- FPHP Plans & Specifications
- Qualified Expert Report; Type: _____
- Natural Regeneration Plan
- Shoreline Permit
- Marbled Murrelet Form
- FPBM Appendix(s) _____
- Small Landowner RMAP Checklist
- CMZ Assessment Form
- Hardwood Conversion Form
- Wetland Mitigation Plan
- Water Protocol Surveys
- Modification Form# _____
- Water Classification Worksheet
- Shade Documentation (Stream Shade Assessment Worksheet)
- Watershed Analysis Worksheet
- DFC Printout
- Slope Stability Informational Form

EARR Tax Credit Yes No

ADDITIONAL COMMENTS:

Form completed by L.U.
October, 2016 Version



For DNR Region Office Use Only	
FPA/N #:	2815645
Region:	NW
Received Date:	2-24-2017

Forest Practices Application/Notification Western Washington

PLEASE USE THE INSTRUCTIONS TO COMPLETE THIS APPLICATION. TYPE OR PRINT IN INK.

1. Landowner, Timber Owner and Operator

Legal Name of LANDOWNER <i>Charles Conrad Brenner</i>	Legal Name of TIMBER OWNER (if different than Landowner)	Legal Name of OPERATOR (if different than Landowner)
Mailing Address: <i>9221-157 AVE SE</i>	Mailing Address:	Mailing Address:
City, State, Zip <i>Snohomish, WA 98290</i>	City, State, Zip	City, State, Zip
Phone (360) <i>568-1888</i> Email: <i>425 387-1760</i>	Phone () Email:	Phone () Email:

Home
Call

2. Contact Person

Contact Person: <i>Charles Brenner</i>	Phone (425) <i>387-1760</i> Email:
---	---------------------------------------

3. Landownership information: See instructions

a. No Yes Are you a small forest landowner per RCW 76.09.450?

If yes, continue to b.

b. No Yes Is your entire proposed harvest area on a single contiguous ownership consisting of one or more parcel?

RECEIVED NW REGION

FEB 24 2017

4. If you are harvesting timber, enter the Forest Tax Reporting Account Number of the Timber Owner:

800-832-685

For tax reporting information or to receive a tax number, call the Department of Revenue at 1-800-548-8829.

5. Are you substituting prescriptions from an approved state or federal conservation agreement or watershed analysis?

No Yes Write 'HCP' or 'Using Prescriptions' in tables that apply. Attach or reference prescriptions and/or crosswalks on file at the Region office.

6. What is the legal description of your forest practices?

Section	Township	Range	EW	Tax Parcel Number	County
15	28	6	E	2806 150040 2500	Snohomish

7. When are you planning to begin work on the proposed activity? March '17

8. Is the taxpayer eligible for the EARR Tax Credit?

No Yes

9. Have you reviewed this forest practices activity area to determine whether it may involve historic sites and/or Native American cultural resources? Read the instructions before answering this question.

No Yes

10. Do you have a DNR approved Road Maintenance and Abandonment Plan (RMAP)?

a. No Yes List the RMAP number: _____

If no, continue to b.

b. No Yes Is a Checklist RMAP required (see instructions)?

11. Are there potentially unstable slopes or landforms in the area of your forest practices activity?

No Yes – attach Slope Stability Informational Form. If applicable, attach geotechnical report, the SEPA Environmental Checklist, HCP, or Watershed Analysis prescriptions.

12. Are there potentially unstable slopes or landforms around the area of your forest practices activity?

No Yes – attach Slope Stability Informational Form. If applicable, attach geotechnical report, HCP, or Watershed Analysis prescriptions.

13. Is this forest practice application/notification (answer every question):

a. No Yes Within city limits or inside an urban growth area? If yes, see instructions for additional required documents.

b. No Yes For road work that is included in an approved Road Maintenance and Abandonment Plan (RMAP)?

c. No Yes Within a public park? If yes, include SEPA Environmental Checklist or SEPA Determination - except for harvest/salvage of less than 5,000 board feet within a developed public park.

d. No Yes Within 500 feet of a public park? Park name: _____

e. No Yes In an approved Conversion Option Harvest Plan (COHP) from the local government? If yes, include a copy. This only applies to proposals within urban growth areas.

f. No Yes Within 200' of the Ordinary High Water Mark (OHWM) or floodway of Type S water? If yes, check with the county or city to determine whether a substantial development permit is required under the local shorelines master plan.

g. No Yes A request for a multi-year permit? If yes, length requested: 4 years or 5 years. Not everyone qualifies for a multi-year permit. See instructions for details.

Fr. 2815645

- h. No Yes An Alternate Plan? If yes, include a copy.
- i. No Yes Within 50 miles of saltwater and do you own more than 500 acres of forest land in Washington State? If yes, include Marbled Murrelet Form or attach/reference HCP prescriptions.
- j. No Yes In or directly adjacent to a potential Channel Migration Zone (CMZ)? If yes, include CMZ Assessment Form. Attach/reference applicable HCP and/or Watershed Analysis prescriptions.

***** **If not working in or over typed waters, skip to Question 18** *****

You are required to verify Type Np and Ns water types within 200 feet of your proposed forest practices activities prior to submitting a Forest Practices Application / Notification. Use the Additional Information section, additional pages, the Water Type Classification Worksheet, and/or a Water Type Modification form to explain how you verified water types. See Water Typing Requirements in the instructions.

Prior to answering Questions 14-17 in this section please refer to the Forest Practices Application Instructions and Forest Practices Board Manual Section 5.

14. Are you proposing any of the following projects NOT permitted by current HPAs from WDFW?

- a. No Yes Installing, replacing, or repairing a culvert at or below the bankfull width of Type S or F water(s) that exceeds a five percent gradient?
- b. No Yes Constructing, replacing, or repairing a bridge at or below the bankfull width of unconfined streams in Type S or F water(s)?
- c. No Yes Placing fill material within the 100-year flood level of unconfined streams in Type S or F water(s)?

15. Have you consulted with DNR and/or WDFW about the proposed hydraulic project(s) in or over Type S or F water? No Yes

16. If installing, replacing, removing, or maintaining structures in or over any typed water, complete the table below. Type S and F waters require detailed plan information. Provide plan details in Question 31 or attach plan to the FPA/N. Provide crossing locations and identifiers on your Activity Map. A detailed plan with profiles may also be required for more complex hydraulic projects in Type N Waters per WAC 222-24-042(2).

Crossing Identifier (letter and/or number)	Water Type (S, F, Np, Ns)	*Existing HPA Number (if applicable)	HPA Expiration Date (if applicable)	Planned Activity (install, replace, remove, temporary, structure maintenance)	Structure (culvert, bridge, ford**, punchon, arch, other)	Proposed Size (dimensions of structure)	Culvert Design Method (No-slope, Stream-sim, Hydraulic, Other) (F and S only)	Channel Bed Width (ft) (F and S only)	Stream Gradient (%) (F and S only)	RMAP Project (Y or N)	FFFPP Project (Y or N)

*Existing HPAs issued by WDFW will be complied and enforced by WDFW until expiration. Plan details are not required for hydraulic projects permitted with an existing HPA (see instructions).

** Fords and equipment crossings on Type S and F Waters may result in an unauthorized incidental take of certain endangered or threatened fish species. For more information, see 'Background for the State's Incidental Take Permits for certain endangered and threatened fish species' following Question 24 of the FPA/N Instructions.

17. If conducting any of the following activities in or over typed water, complete the table below. Some activities will require identifiers on the Activity map and/or more information in Question 31. See instructions.

*Activity	Type S Water	Type F Water	Type Np Water	Type Ns Water
Equipment Crossing**				
Suspending Cables				
Cable Yarding				
LWD Placement/Removal				
Beaver Dam Removal				
Felling and Bucking				
Other (describe in Question 31)				

*Existing HPAs issued by WDFW will be complied and enforced by WDFW until expiration. Plan details are not required for hydraulic projects permitted with an existing HPA (see instructions).

** Fords and equipment crossings on Type S and F Waters may result in an unauthorized incidental take of certain endangered or threatened fish species. For more information, see 'Background for the State's Incidental Take Permits for certain endangered and threatened fish species' following Question 24 of the FPA/N Instructions.

18. If constructing or abandoning forest roads, complete the table below. Show the road locations and identifiers on the Activity Map. Include abandonment plans for temporary roads and abandonment projects.

Road Identifier (name, number)	Road Construction		Road Abandonment	
	Length (feet)	Steepest Side-slope (%)	Length (feet)	Abandonment Date

19. If depositing spoils and/or expanding or developing a rock pit for forestry use, complete the table below. Show locations and identifiers on the Activity Map.

Spoil Area Identifier (letter, number)	Amount of Spoils Deposited (cubic yards)	Rock Pit Identifier (name, number or letter)	Acres of New Rock Pit Developed	Acres of Existing Rock Pit Expanded

20. If operating in or within 200 feet of a wetland, complete the table below. Show the boundaries of each wetland, along with its identifier, and WMZ on the Activity Map. See instructions for information.

Wetland Identifier (number, letter)	Wetland Type (A, B, or Forested)	Planned Activities in Wetland	Planned Activities in Maximum Width WMZ	Total Wetland Area (acres)	How many acres will be drained?	How many acres will be filled?

***** **If not harvesting or salvaging timber, skip to Question 29** *****

21. If harvesting or salvaging timber, complete the table below. Show all harvest areas and unit numbers on the Activity Map. For even-aged harvest units, also show surrounding stand information on the Activity Map.

Unit Number	Harvest Type (Even-aged, Uneven-aged, Salvage, Right-of-Way)	Biomass Harvest (Y/N)	Harvest Method (Rubber Tired Skidder, Tracked Skidder, Dozer, Shovel, Full Suspension Cable, Lead-end Suspension Cable, Helicopter, Animal, Chipper-forwarder, Slash Bundler)	Acres to be Harvested	Volume to be Harvested (mbf)	Volume to be Harvested (biomass tonnage)	Volume to be Harvested (%)	Steepest Slope in Harvest Unit (%)
1	12 acres		track hoe	8.4	25		90	190

22. Reforestation. Check the appropriate box(es).

Planting. Tree Species: Cedar

Natural. Include a Natural Regeneration Plan

Not required because of one or more of the following:

I am converting some or all of this land to non-forest land in the next 3 years or lands are exempted under WAC 222-34-050.

Individual dead, dying, down, or wind-thrown trees will be salvaged.

Trees are removed under a thinning program reasonably expected to maximize the long-term productivity of commercial timber.

I am leaving at least 100 vigorous, undamaged, and well-distributed saplings or merchantable trees per acre.

An average of 190 tree seedlings per acre are established on the harvest area and my harvest will not damage it.

Road right-of-way or rock pit development harvest only.

**** **If you own MORE than 80 forested acres in Washington, skip to Question 27** ****

23. Are you using the exempt 20-acre parcel riparian management zone (RMZ) rule on type S, F, or Np waters?

No If no, continue to Question 27.

Yes If yes, continue to Question 24. See instructions for qualifications and information.

24. Choose the answer below that best fits your situation. Show all RMZs on the Activity Map.

a. ALL of the following apply to me and my land: (If no, answer b.)

- Between June 5, 2006 and today's date I have always owned less than 80 acres of forestland in Washington.

- Between June 5, 2006 and today's date this parcel has always been 20 acres or less of contiguous ownership. See RCW 76.09.020 for definition of 'contiguous'.

- Between June 5, 2006 and today's date this parcel has always been owned by me or someone else that has owned less than 80 acres of forestland in Washington.

b. ONE OR MORE of the following apply to me and/or my land (check all that apply):

- I currently own more than 80 acres of forestland in Washington.
- Between June 5, 2006 and today's date I have owned more than 80 acres of forestland in Washington.
- Between June 5, 2006 and today's date this parcel has been a part of more than 20 acres of contiguous ownership. See RCW 76.09.020 for definition of 'contiguous'.
- Between June 5, 2006 and today's date this parcel has been owned by someone that has owned more than 80 forested acres in Washington.

If any of the statements in (b) above apply AND you use the 20-acre exempt RMZ rule, you are NOT authorized under the State's Incidental Take Permits (see explanation in FPA instructions under Questions 24).

25. If harvesting within 115 feet of a Type S or F water on an exempt 20-acre parcel, complete the table below. Show RMZs and stream segment identifiers on the Activity Map. If you are harvesting within 75 feet or within the maximum RMZ (whichever is less), stream shade must be assessed and met following harvest. Describe how stream shade was determined to be met, using the 'Stream Shade Assessment Worksheet' if necessary.

Stream Segment Identifier (letter)	Water Type (S, F)	Segment Length (feet)	Bankfull Width (feet)	Maximum RMZ Width (feet)	Are you harvesting within the maximum RMZ? (Y or N)

26. Are you harvesting within 29 feet of a Type Np water on a 20-acre exempt parcel?

- No Continue to Question 29.
- Yes See instructions and describe leave tree strategy in Question 31. Then continue to Question 29.

27. If harvesting within 200 feet of any of Type S or F water, complete the table below. Include DFC for all inner zone harvests unless you have an HCP prescription. Show RMZs, CMZs, and stream segment identifiers on the Activity Map. If you are harvesting within 75 feet or within the maximum RMZ (whichever is less), stream shade must be assessed and met following harvest. Describe how stream shade was determined to be met, using the 'Stream Shade Assessment Worksheet' if necessary.

Stream Segment Identifier (letter)	Water Type (S or F)	Site Class (I - V)	Stream Width (feet)	Is there a CMZ? (Y/N)	RMZ Harvest Code(s) (see instructions)	DFC Run Number	Total width of RMZ (feet)

28. If harvesting within 50 feet of Type Np water, complete the table(s) below. Show RMZs and stream segment identifiers on the Activity Map.

Stream Segment Identifier (letter)	Total Stream Length in Harvest Unit (feet)	Length of No-Harvest, 50-foot Buffers in Harvest Unit (feet)	Stream Segment Identifier (letter)	Total Stream Length in Harvest Unit (feet)	Length of No-Harvest, 50-foot Buffers in Harvest Unit (feet)

29. How are the following marked on the ground? (Flagging, paint, road, fence, etc.)

Harvest Boundaries: _____

Clumped Wildlife Reserve Trees/Green Recruitment Trees: _____

Right-of-way limits/road centerlines: _____

Stream Crossing Work: _____

Riparian Management Zone Boundaries and Leave/Take Trees: _____

Channel Migration Zone: _____

Wetland Management Zone Boundaries and Leave/Take Trees: _____

30. Are you converting the land to non-forestry use within 3 years of harvest?



No Yes If yes, include your SEPA Determination and/or SEPA checklist.

31. Additional Information (attach additional pages if necessary): For hydraulic projects in or over Type S, F, or complex N water(s) see instructions for required plan information.

32. We acknowledge the following:

- The information on this application/notification is true.
- We understand this proposed forest practice is subject to:
 - The Forest Practices Act and Rules AND
 - All other federal, state or local regulations.
- Compliance with the Forest Practices Act and Rules does not ensure compliance with the Endangered Species Act or other federal, state or local laws.
- If we said that we would not convert the land to non-forestry use, the county or city may deny development permits on this parcel for the next 6 years.
- The following may result in an unauthorized incidental take of certain endangered or threatened fish species:
 - Conversion of land to non-forestry use.
 - Harvesting within the maximum RMZ on a 20-acre exempt parcel that was acquired after June 5, 2006.
 - Equipment Crossings/Fords in or over Type S and F Waters.
- Inadvertent Discovery – Chapters 27.44, 27.53, 68.50 and 68.60 RCW
 - If you find or suspect you have found an archaeological object or Native American cairn, grave, or glyptic record, immediately cease disturbance activity, protect the area and promptly contact the Department of Archaeology and Historic Preservation at 360 586-3077.
 - If you find or suspect you have found human skeletal remains, immediately cease disturbance activity, protect the area, and contact the County Coroner or Medical Examiner and local law enforcement as soon as possible. Failure to report human remains is a misdemeanor.

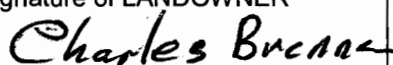
The landowner understands that by signing and submitting this FPA, he/she is authorizing the Department of Natural Resources to enter the property in order to review the proposal, inspect harvest operations, and monitor compliance for up to three years after its expiration date. RCW 76.09.150

Signature of LANDOWNER  Print Name:  Date: <u>2/24/17</u>	Signature of TIMBER OWNER* (If different than landowner) Print Name: Date:	Signature of OPERATOR (If different than landowner) Print Name: Date:
---	---	--

* NOTE: If you are a "Perpetual Timber Rights Owner," and are submitting this without the Landowner's Signature, provide written evidence the landowner has been notified.

Please make a copy of this FPA/N for your records. If this FPA/N contains a hydraulic project requiring WDFW concurrence review, it will not be available online for public review until after the WDFW concurrence review period.



Forest Practices Risk Assessment Mapping (FPRAM)

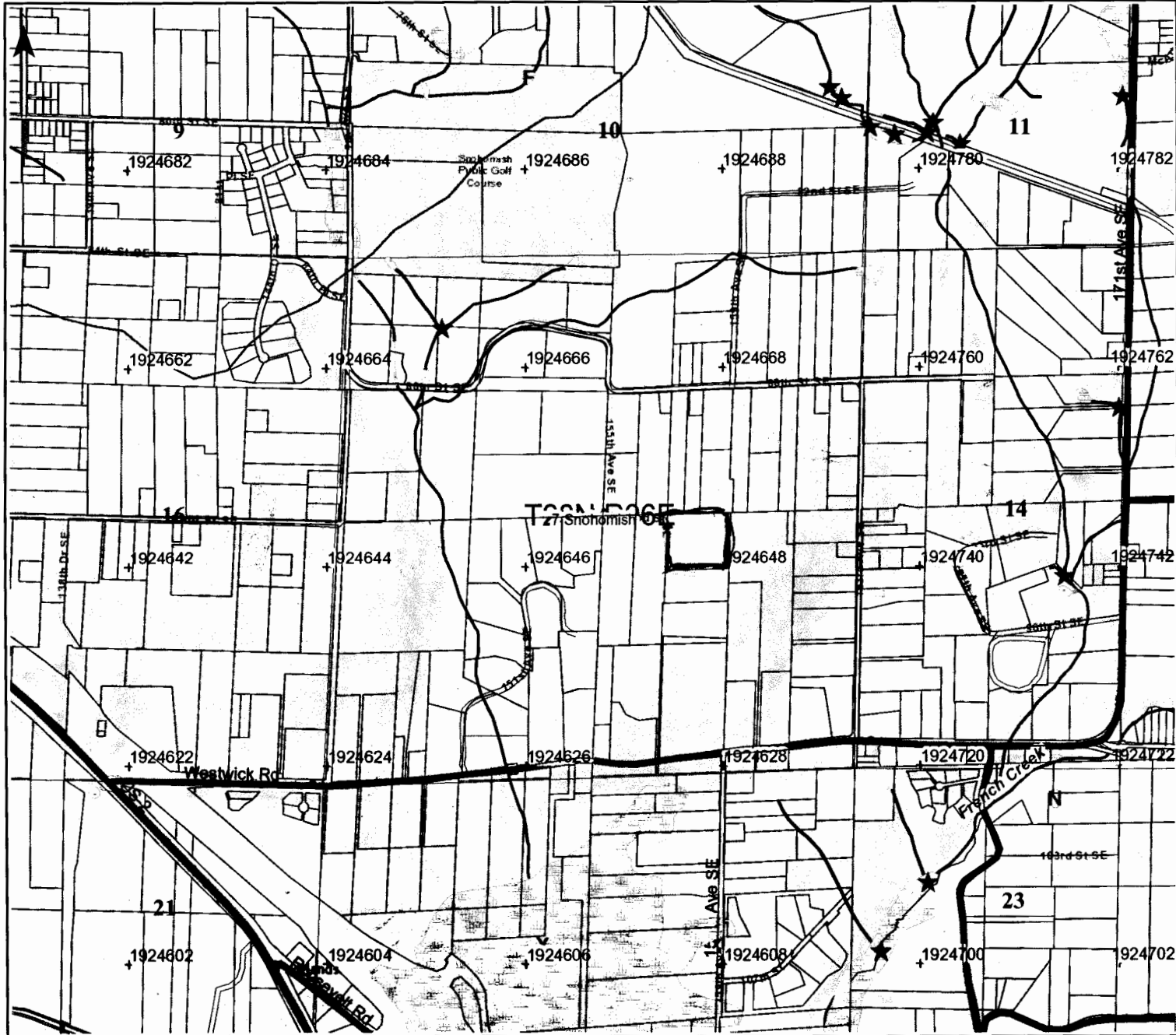

Legend

+	Tics - 2000' Interval	—	Type F
	Tics - 2000' Interval - Labels	—	Type N
	WRIAs (Labels)	—	Type S
□	WAUs	U, unknown
★	Water Type Breaks (DNR)	X, non-typed per WAC 222-16
Water Bodies (DNR)		Trails and Railroads	
▨	Other Impoundments	- - -	Trail
□	Open Freshwater	+	Railroad
▨	Subject to Inundation	≡	Railroad Grade
▨	Glacier / Snowfield	Roads	
▨	Wet Area	≡	Unpaved Road/Surface Unknown
▨	Open Saltwater	—	Paved Road
▨	Artificial Feature	□	Tribal Cultural Resource Contacts - All
▨	Unknown / Unclassified	▨	City and Urban Growth Area Boundaries
Water Courses - Typed (DNR)		▨	incorporated
		▨	Unincorporated
		□	Public Land Survey Sections
		□	Public Land Survey Sections (labels)
		□	Public Land Survey Townships
		□	Public Land Survey Townships (labels 0-200k)
		□	County Boundaries

Approximate Scale : 1:18,056

2/7/2017 11:36:02 AM

Coordinate System: NAD 1983 HARN StatePlane Washington South FIPS 4602 Feet



WASHINGTON STATE DEPT OF
NATURAL RESOURCES

Extreme care was used during the compilation of this map to ensure accuracy. However, due to changes in data and the need to rely on outside information, the Department of Natural Resources cannot accept responsibility for errors or omissions, and therefore, there are no warranties which accompany this material.

Fr 15645



Forest Practices
Informal Conference Note

ICN No. 135518	Legal Subdivision SE 1/4	Section 15	TWP 28	RGE E/W 6E	Application / Notification #	Class
Landowner Charles Brenner		Timber Owner Same as landowner		Operator Same as landowner		
Mailing Address 9221 157 th Ave SE		Mailing Address		Mailing Address		
City, State /Province), Zip /Postal Code) Snohomish, WA 98290		City, State /Province), Zip /Postal Code		City, State /Province), Zip /Postal Code)		
Meeting Location N/A – on site		Telephone Conference <input checked="" type="checkbox"/>	Date 2/13/2017	Time 1430	Region NW	

Subjects Discussed:

Landowner requested an on-site review to determine how to fill out the reforestation question for the FPA he is preparing. There are an existing house and outbuildings on the property parcel. The trees proposed for harvest are scattered throughout the property with managed lawn in between the trees. Approximately 50 cedar trees are planned for harvest.

Snohomish County Property Parcel Number: 28061500402500 approximately 8.33 acres
Site address: 9221 157th Ave SE, Snohomish

Decisions Made:

Reforestation will be required only in areas where trees are harvested. Standard TPA and seedling spacing is not applicable for this proposal. It was agreed that 2 or 3 cedar seedlings will be planted at sites where any trees are harvested. Landowner does not have to plant seedlings in the grass/lawn area.

PRINT Participants' Names Charles Brenner	*SIGNATURES of Participants <i>Steven Huang by L. Utgaard</i>	Representing landowner	Copies Mailed <input type="checkbox"/> <input type="checkbox"/> <input type="checkbox"/> <input type="checkbox"/> <input type="checkbox"/>
Position No. 2925	Signature & Title of DNR Representative Steven Huang Forest Practice Forester	Date 2/15/2017	Work Phone (360)770-9806

* (Participant signature means Note is correct for subjects discussed and decisions made at the meeting.)

Did not attend -- mail copies to: WFPARM, FPDM, FPCOORD, SKY30

Timber Owner Landowner Others: SNOCO, ECY, DFW, DOR, TULALIP